

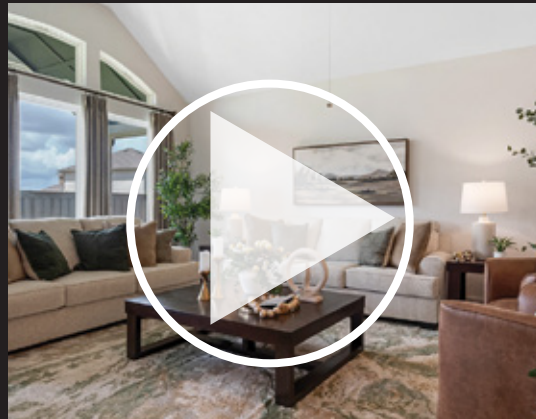

CASTLEROCK COMMUNITIES

Sunfield | Buda, TX



This stunning master-planned community, located in the heart of Buda, is one of Austin's fastest growing areas. Sunfield offers numerous options of uniquely planned homes to suit almost any lifestyle. Perfectly situated, this community is just 15 minutes away from the vibrant cities of Austin and San Marcos. Children will go to school in the highly acclaimed Hays ISD. Sunfield has it all - especially with amenities like the resort-style pool, children's splash pad, hiking & biking trails, a covered pavilion, and an open field for sports. The main attraction is the brand-new lazy river amenity center boasting over 25,000 sqft of pool deck, picnic tables, pavilions, grill stations, and more! If you're searching for a small-town feel, accompanied with magnificent architectural detail, then Sunfield is the place for you.



SUNFIELD

Buda, Texas 78610
Phone: 737-999-0502

Property Tax Information

Northeast Hays Co. ESD #2	\$0.065000
Hays Co ESD #8	\$0.082600
Hays County	\$0.287500
Special Road Dist	\$0.020000
Hays Cons ISD	\$1.156900
Sunfield Mud #3	\$0.900000
Austin Community College Dist	\$0.098600

Total Tax Rate (before homestead) \$2.610600

Homeowner's Association

Annual Assesment (HOA DUES)	\$800
First Service Residential	512-312-4526

Emergency Numbers 911

Hays Co Sheriff	512-393-7896
Fire Dept	512-295-2232

Local Utility/Service Providers

Sunfield Mud	512-312-0084
Phone (Spectrum)	512-485-5555
Electric (PEC)	888-554-4732
Gas (Texas Gas Company)	800-700-2443
Water/Sewer (Go Forth)	512-376-5695
Cable (Spectrum Fiber)	855-707-7328
Trash (TX Disposal Systems)	884-873-7734

Public Services

US Post Office	512-295-4241
----------------	--------------

Area Churches

All denominations available

Community Schools

Sunfield Elementary	512-268-8517
<i>Vista Gardens Drive</i>	
McCormick Middle School	512-268-8508
<i>5700 Dacy Lane</i>	
Johnson High School	512-268-8512
<i>4260 FM 967</i>	

Private Schools Daycares

Huntington Learning Center	512-252-1549
Strickland School	512-447-1447
Rocking Horse Academy	512-405-3700
Doral Charter School	512-436-3881

Colleges

Texas State University
University of Texas
St. Edwards University
Austin Community College

Grocery Stores

HEB
Walmart Super Center

Shopping-Retail

San Marcos Outlet Mall
Walmart Super Center
South Park Meadows
Cabela's





Sunfield 45's

Cobalt Series Homes

EXTERIOR DETAILS

- Exclusive designed elevations with
- Enhanced elevations featuring board and batten in lieu of front-elevation siding
- Upgrade elevations available with brick or stone per plan
- Class A, 25-year Black Shadow shingles
- Cementitious fiber cement siding, fascia, soffit & trim
- Insulated raised-panel fiberglass entry door
- Insulated steel garage doors with decorative hardware and pre-wire for automatic opener
- 16-foot driveway with 3-foot privacy walk to entry
- Decorative black address numbers

ELEGANT INTERIORS

- 9-foot ceiling heights in primary living areas and master per plan
- Straight-edge sheetrock corners throughout
- Raised-panel interior doors with decorative casing
- Kwikset satin nickel door hardware
- Monterey drag texture at ceilings and walls
- Choice of ceramic tile at entry, kitchen/breakfast, baths, and utility
- Shaw carpet over 3/8-inch pad
- Choice of one-color interior with low-VOC
- Decorative wood base throughout home
- Nickel finish ceiling fan with light kit in family room
- Kichler designer light fixtures

CHEF'S KITCHEN

- GE free-standing gas range, dishwasher and space-saving external-venting microwave
- Birch cabinets with 42-inch uppers and choice of colors
- Hard-surface countertops
- Ceramic tile backsplash
- Stainless steel undermount single bowl sink with Chrome faucet
- 1/3 HP garbage disposal
- Flush-mounted LED downlighting in kitchen per plan

LUXURIOUS BATHS

- Bath cabinetry will match kitchen selection
- Hard-surface countertops with square edge and undermount rectangular sinks (dual vanities per plan)
- Oversized soaker tub in master bath
- Master bath includes separate tub and shower with 3X6 white tile shower and tub surround over backerboard and a garden window
- Secondary bath/tub shower has 3X6 white tile over backerboard
- Chrome bath accessories (faucets and hardware)
- White pedestal sink and decorative mirror at powder per plan
- Elongated toilets throughout plan

ENERGY EFFICIENCY FEATURES

- Energy-efficient, dual-pane windows with LowE360 glass and vinyl frames with argon gas
- Energy-efficient HVAC system with fresh air intake and media filter(s)
- Gas-fired tankless water heater sized per plan
- R-38 blown fiberglass in attic areas above conditioned space
- Min R-13 Fiberglass BATT insulation in 2x4 walls next to conditioned space, per plan
- Min R-19 fiberglass BATT insulation in 2x6 walls next to conditioned space, per plan
- Passive attic ventilation per plan
- Poly seal on all base plate and wood penetrations to exterior
- Honeywell programmable thermostat(s)
- High-efficiency LED lighting throughout
- Water-saving shower heads and faucets
- Third-party insulation inspections

ENGINEERING & ADVANCED COMFORT TECHNOLOGY

- Professionally engineered and designed post-tension foundations
- Engineered framing designs
- Smoke detectors in bedrooms and halls with battery back-up
- PEX water distribution system with main water shut-off valve
- Media outlet (data line & cable TV) at family room per plan
- Cable TV pre-wire at master and game room per plan
- Lighted front entry doorbell

LANDSCAPING PACKAGE

- Eight 5-gallon shrubs in front yard
- One 2" caliper oak tree
- Fully fenced rear yard per community guidelines
- Fully sodded front, side
- Automatic sprinkler system at front
- Gutters at front, sides, and rear of home
- Two exterior hose bibs per plan with anti-siphoning device

CUSTOMER SERVICE HIGHLIGHTS

- One-year warranty for materials and workmanship
- Two-year warranty on mechanical systems (HVAC, Electrical, Plumbing)
- Six-year structural component warranty
- Professional decorator assistance with one 2-hour appointment
- Pre-start meeting with our team
- Pre-sheetrock meeting with our team
- Pre-move in orientation meeting with construction manager

01/19/2026



COMMUNITY BUILDER WITH A ROCK SOLID FOUNDATION

C-ROCK.COM



Sunfield

Silver Series Homes

EXTERIOR DETAILS

- Exclusive designed elevations
- Brick on front and sides to 9' per plan
- Brick front entry walls
- Class A, 25-year Black Shadow Shingles
- Custom address block
- Cementitious fiber cement siding, fascia, soffit & trim
- James Hardie window trim
- Stained mahogany six panel front door with nickel finish handle set
- Insulated steel garage door with pre-wire for automatic opener
- 10' x 10' broom finished concrete rear patio
- 16-foot driveway with 3-foot privacy walk to entry
- Cedar wood railing on exterior balconies per plan

ELEGANT INTERIORS

- 9-foot ceiling heights in primary living areas and master, per plan
- Art niches and archways, per plan
- Raised-panel interior doors with casing
- Square-edge sheetrock corners throughout
- Kwikset satin nickel door hardware
- Monterey drag texture at ceilings and walls
- Choice of LVP at entry, kitchen/breakfast, baths, utility and family/living room
- Wide selection of carpet in all bedrooms, bedroom closets, second floor, and stairs, per plan
- Shaw carpet over 3/8-inch pad
- Choice of one-color interior with low-VOC paint
- Wood base throughout home
- Wood shelving and hanging rods in closets, per plan
- Ceiling fan with light kit in family room
- Kichler designer light fixtures

CHEF'S KITCHEN

- GE slide in gas range, dishwasher and space saving external venting microwave
- Birch cabinetry with flat-panel doors
- 42-inch uppers and choice of colors
- Hard-surface countertops
- Ceramic tile backsplash
- Stainless steel single-bowl undermount sink with chrome faucet
- 1/3 HP garbage disposal
- Flush-mounted LED down-lighting in kitchen, per plan

LUXURIOUS BATHS

- Bath cabinetry will match kitchen selection
- Hard-surface countertops with square edge and undermount rectangular sinks (dual vanities per plan)
- Oversized soaker tub in master bath
- Master bath includes separate tub and shower with ceramic tile shower, tub surround and a garden window tub surround over backerboard and a garden window
- Secondary bathtub/shower with ceramic tile over backerboard
- Chrome bath accessories (faucets and hardware)
- White pedestal sink and decorative mirror at powder, per plan
- Elongated toilets throughout

ENERGY EFFICIENCY FEATURES

- Energy-efficient, dual-pane windows with LowE360 glass and vinyl frames with argon gas
- Energy-efficient HVAC system with fresh air intake and media filter(s)
- Gas-fired tankless water heater sized per plan
- R-38 blown fiberglass in attic above conditioned space, per plan
- Min R-13 fiberglass BATT insulation in 2x4 walls next to conditioned space, per plan
- Min R-19 fiberglass BATT insulation in 2x6 walls next to conditioned space, per plan
- Passive attic ventilation, per plan
- Poly seal on all base plate and wood penetrations to exterior
- Programmable thermostat(s)
- High-efficiency LED lighting throughout
- Water-saving shower heads and faucets
- Third-party insulation inspection

ENGINEERING & ADVANCED COMFORT TECHNOLOGY

- Professionally engineered and designed post-tension foundations
- Engineered subfloor I beam systems on all two-story homes
- Coach lights at front, rear and garage door per plan
- Alarm pre-wire with contacts at first-floor doors, pre-wire with blank plates for two keypad locations and motion or glass break detector locations at all first-floor main rooms
- Smoke detectors in bedrooms and halls with battery back-up
- PEX water distribution system with main water shut-off valve
- Media outlet (data line & cable TV) at family, master, study, and media per plan
- Cable TV pre-wire at game room per plan
- Lighted front entry doorbell

LANDSCAPING PACKAGE

- Four 5-gallon shrubs and twelve 1-gallon shrubs in front yard
- Two 2" caliper shade trees in front yard
- Two exterior hose bibs anti-siphoning devices
- Fully sodded front and rear yards with front sprinkler system
- Gutters at front, side and rear per plan

CUSTOMER SERVICE HIGHLIGHTS

- Two-year warranty for materials and workmanship (see warranty)
- Ten-year structural component warranty (see warranty)
- Professional decorator assistance with two 2-hour appointments
- Pre-start meeting with our team
- Pre-sheetrock meeting with our team
- Pre-move in orientation meeting with construction manager

01/19/2026





Sunfield 60's

Silver Series Homes

EXTERIOR DETAILS

- Exclusive designed elevations
- Brick on front and sides to 9' per plan
- Brick front entry walls
- Class A, 25-year Black Shadow Shingles
- Custom address block
- Cementitious fiber cement siding, fascia, soffit & trim
- James Hardie window trim
- Stained mahogany six panel front door with nickel finish handle set
- Insulated steel garage door with pre-wire for automatic opener
- 10' x 10' broom finished concrete rear patio
- 16-foot driveway with 3-foot privacy walk to entry
- Cedar wood railing on exterior balconies per plan

ELEGANT INTERIORS

- 9-foot ceiling heights in primary living areas and master, per plan
- Art niches and archways, per plan
- Raised-panel interior doors with casing
- Square-edge sheetrock corners throughout
- Kwikset satin nickel door hardware
- Monterey drag texture at ceilings and walls
- Choice of LVP at entry, kitchen/breakfast, baths, utility and family/living room
- Wide selection of carpet in all bedrooms, bedroom closets, second floor, and stairs, per plan
- Shaw carpet over 3/8-inch pad
- Choice of one-color interior with low-VOC paint
- Wood base throughout home
- Wood shelving and hanging rods in closets, per plan
- Ceiling fan with light kit in family room
- Kichler designer light fixtures

CHEF'S KITCHEN

- GE slide in gas range, dishwasher and space saving external venting microwave
- Birch cabinetry with flat-panel doors
- 42-inch uppers and choice of colors
- Hard-surface countertops
- Ceramic tile backsplash
- Stainless steel single-bowl undermount sink with chrome faucet
- 1/3 HP garbage disposal
- Flush-mounted LED down-lighting in kitchen, per plan

LUXURIOUS BATHS

- Bath cabinetry will match kitchen selection
- Hard-surface countertops with square edge and undermount rectangular sinks (dual vanities per plan)
- Oversized soaker tub in master bath
- Master bath includes separate tub and shower with ceramic tile shower, tub surround and a garden window tub surround over backerboard and a garden window
- Secondary bathtub/shower with ceramic tile over backerboard
- Chrome bath accessories (faucets and hardware)
- White pedestal sink and decorative mirror at powder, per plan
- Elongated toilets throughout

ENERGY EFFICIENCY FEATURES

- Energy-efficient, dual-pane windows with LowE360 glass and vinyl frames with argon gas
- Energy-efficient HVAC system with fresh air intake and media filter(s)
- Gas-fired tankless water heater sized per plan
- R-38 blown fiberglass in attic above conditioned space, per plan
- Min R-13 fiberglass BATT insulation in 2x4 walls next to conditioned space, per plan
- Min R-19 fiberglass BATT insulation in 2x6 walls next to conditioned space, per plan
- Passive attic ventilation, per plan
- Poly seal on all base plate and wood penetrations to exterior
- Programmable thermostat(s)
- High-efficiency LED lighting throughout
- Water-saving shower heads and faucets
- Third-party insulation inspection

ENGINEERING & ADVANCED COMFORT TECHNOLOGY

- Professionally engineered and designed post-tension foundations
- Engineered subfloor I beam systems on all two-story homes
- Coach lights at front, rear and garage door per plan
- Alarm pre-wire with contacts at first-floor doors, pre-wire with blank plates for two keypad locations and motion or glass break detector locations at all first-floor main rooms
- Smoke detectors in bedrooms and halls with battery back-up
- PEX water distribution system with main water shut-off valve
- Media outlet (data line & cable TV) at family, master, study, and media per plan
- Cable TV pre-wire at game room per plan
- Lighted front entry doorbell

LANDSCAPING PACKAGE

- Four 5-gallon shrubs and twelve 1-gallon shrubs in front yard
- Two 2" caliper shade trees in front yard
- Two exterior hose bibs anti-siphoning devices
- Fully sodded front and rear yards with front sprinkler system
- Gutters at front, side and rear per plan

CUSTOMER SERVICE HIGHLIGHTS

- Two-year warranty for materials and workmanship (see warranty)
- Ten-year structural component warranty (see warranty)
- Professional decorator assistance with two 2-hour appointments
- Pre-start meeting with our team
- Pre-sheetrock meeting with our team
- Pre-move in orientation meeting with construction manager

01/19/2026





Sunfield 60s

Gold Series Homes

EXTERIOR DETAILS

- Beautifully designed elevations
- Brick on front and sides to 10' per plan
- Two-story homes will have brick rear to 10' per plan
- Brick/stone/stucco front elevations per plan
- 30-year Dimensional Black Shadow shingles
- Custom address block
- Cementitious fiber cement siding, fascia, soffit & trim
- Stained mahogany front door with leaded glass insert
- Nickel finish handle set at front door with decorative deadbolt
- Insulated steel garage door with automatic opener and two remotes
- 16-foot driveway with 3-foot privacy walk to entry
- Covered rear patio sized per plan with wood column(s)
- Cedar wood railing on exterior balconies per plan

ELEGANT INTERIORS

- Art niches and archways per plan
- Raised-panel interior doors with decorative casing; 8' tall interior doors locations, 6'8" doors at second floor locations
- Square-edge sheetrock corners throughout
- Satin Nickel finish door hardware and light fixtures (see specs)
- Monterey drag texture at ceilings and walls
- LOW-VOC choice of one interior paint color
- LOW-VOC white ceiling, trim paint
- Choice of LVP at entry, kitchen/breakfast, baths and utility
- Wide selection of carpet in all bedrooms, bedroom closets, second floor, and stairs, per plan
- Shaw carpet over 3/8-inch pad
- Wood base throughout home
- Wood shelving and hanging rods in closets per plan
- Nickel finish ceiling fan with light kit in family room and master
- 42" direct vent fireplace with ceramic tile surround and MDF mantle
- Two-story homes have stained oak handrails and wrought iron balusters per plan
- Insulated glass panel door at rear entry
- Kichler designer light fixtures

CHEF'S KITCHEN

- High ceilings per plan
- Birch cabinets with 42-inch uppers with pot & pan drawers beneath and Trash Can pull out in a choice of colors
- GE built-in stainless steel appliance package including 36" gas cooktop, microwave, wall oven, external venting hood, and dishwasher
- Well-designed workspace with island at kitchen per plan
- Flush-mounted LED down lighting at kitchen per plan
- Hard-surface countertops
- Ceramic tile backsplash
- Stainless steel single bowl undermount sink with chrome faucet
- 1/3 HP garbage disposal

LUXURIOUS BATHS

- Bath cabinetry will match kitchen selection
- Hard-surface countertops square edge and integral rectangular sinks (dual vanities per plan)
- Free standing tub with, tile surround and deck-mount faucet at master bath
- Master has separate tub and shower with garden window and 3x6 ceramic tile shower surround over backerboard
- Secondary bath surround includes 3x6 ceramic tile over backerboard throughout
- Satin Nickel finish accessories at master bath and powder room, bath faucets and accessories at secondary baths
- White pedestal sink and decorative mirror at powder per plan
- Elongated toilets throughout

ENERGY EFFICIENCY FEATURES

- Energy-efficient, dual-pane windows with LowE360 glass and vinyl frames with argon gas
- Energy-efficient HVAC system with fresh air intake and media filter(s)
- R-38 fiberglass in attic above conditioned space, per plan
- Min R-13 fiberglass BATT insulation in 2x4 walls next to conditioned space, per plan
- Min R-19 fiberglass BATT insulation in 2x6 walls next to conditional space, per plan
- Gas-fired tankless water heater sized per plan
- High efficiency central gas heating
- Passive attic ventilation, per plan
- Poly seal on all base plate and wood penetrations to exterior
- Programmable thermostat
- High-efficiency LED lighting throughout
- Water-saving shower heads and faucets
- Third party insulation inspections

ENGINEERING & ADVANCED COMFORT TECHNOLOGY

- Professionally engineered/designed post-tension foundations
- Engineered subfloor I beam systems on all two-story homes
- Engineered frame designs
- Coach lights at front, rear and garage door per plan
- PEX water distribution system with main water shut-off access
- Media outlet (data line & cable TV) at family, master, study, and media per plan
- Cable TV pre-wire at game room per plan
- Alarm wiring with contacts at first-floor doors, one control panel, one keypad, one motion detector at family, one siren, plus pre-wire with blank plates for future motion or glass break detector locations at all first-floor main rooms

LANDSCAPING PACKAGE

- Four 5-gallon shrubs and twelve 1-gallon shrubs in front yard
- Two 2" caliper oak trees in front yard
- Two exterior hose bibbs with anti-siphoning devices
- Fully sodded front, side and rear yards with full sprinkler system
- Gutters at front, sides and rear per plan

CUSTOMER SERVICE HIGHLIGHTS

- One-year warranty for materials and workmanship
- Two-year warranty on mechanical systems (HVAC, Electrical, Plumbing)
- Six-year structural component warranty
- Professional decorator assistance with five hours appointments
- Pre-start meeting with our team
- Pre-sheetrock meeting with our team
- Pre-move in orientation meeting with construction manager

05/01/2026



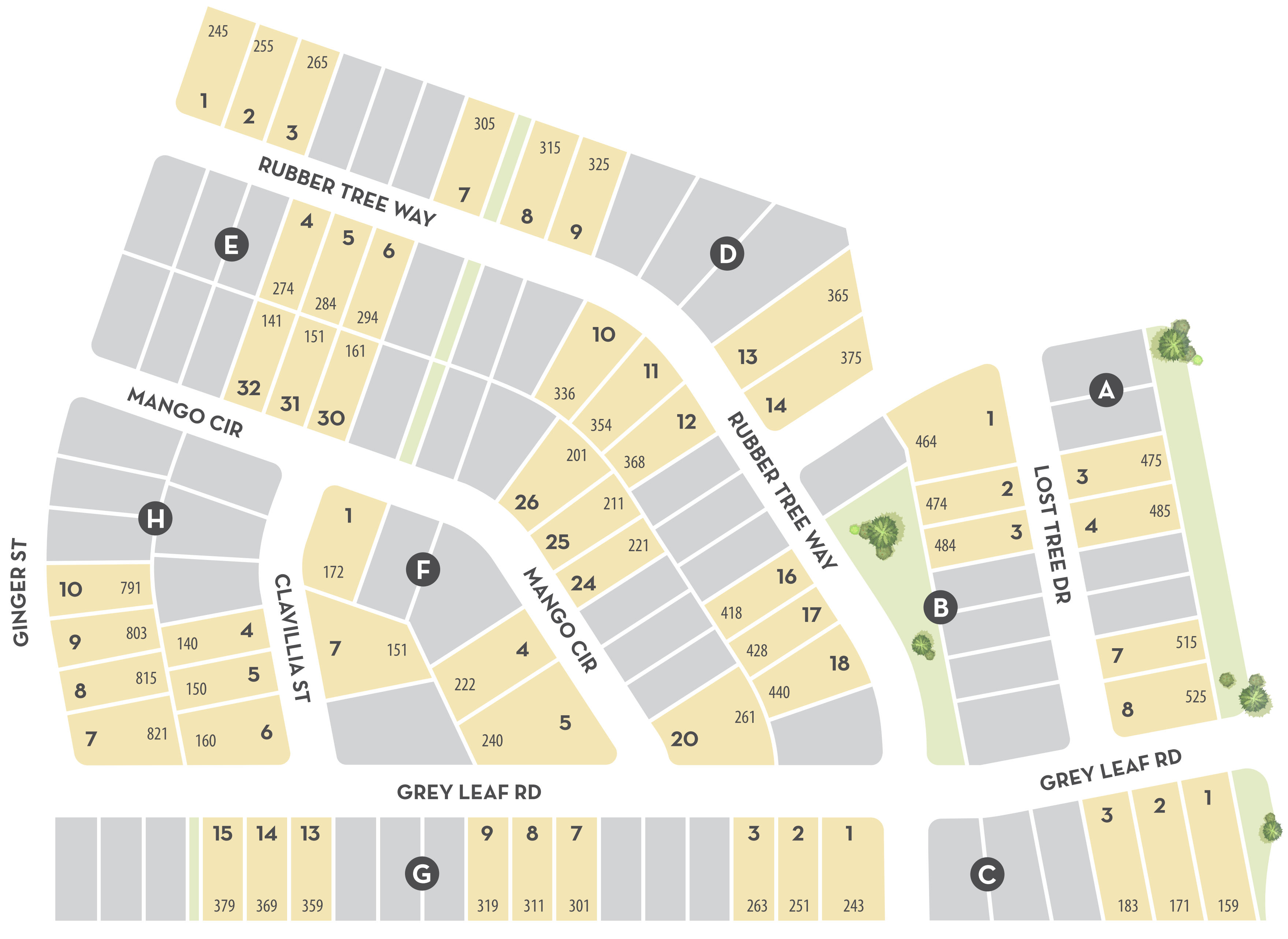

● INVENTORY ● AVAILABLE ● SOLD ● CLOSED

COMMUNITY BUILDER WITH A ROCK SOLID FOUNDATION

C-ROCK.COM

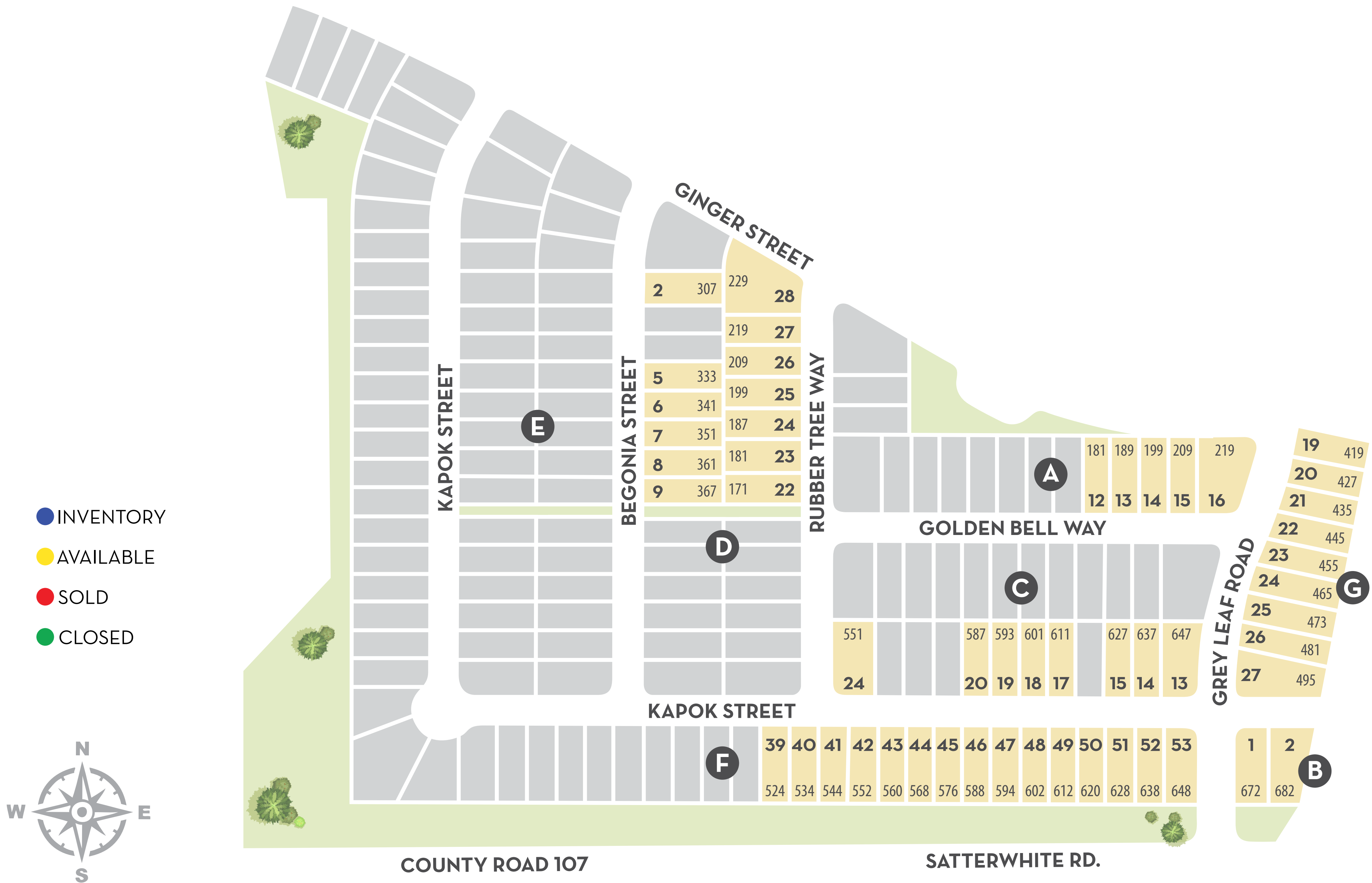

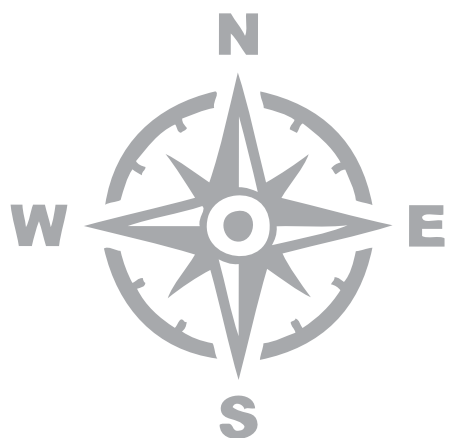
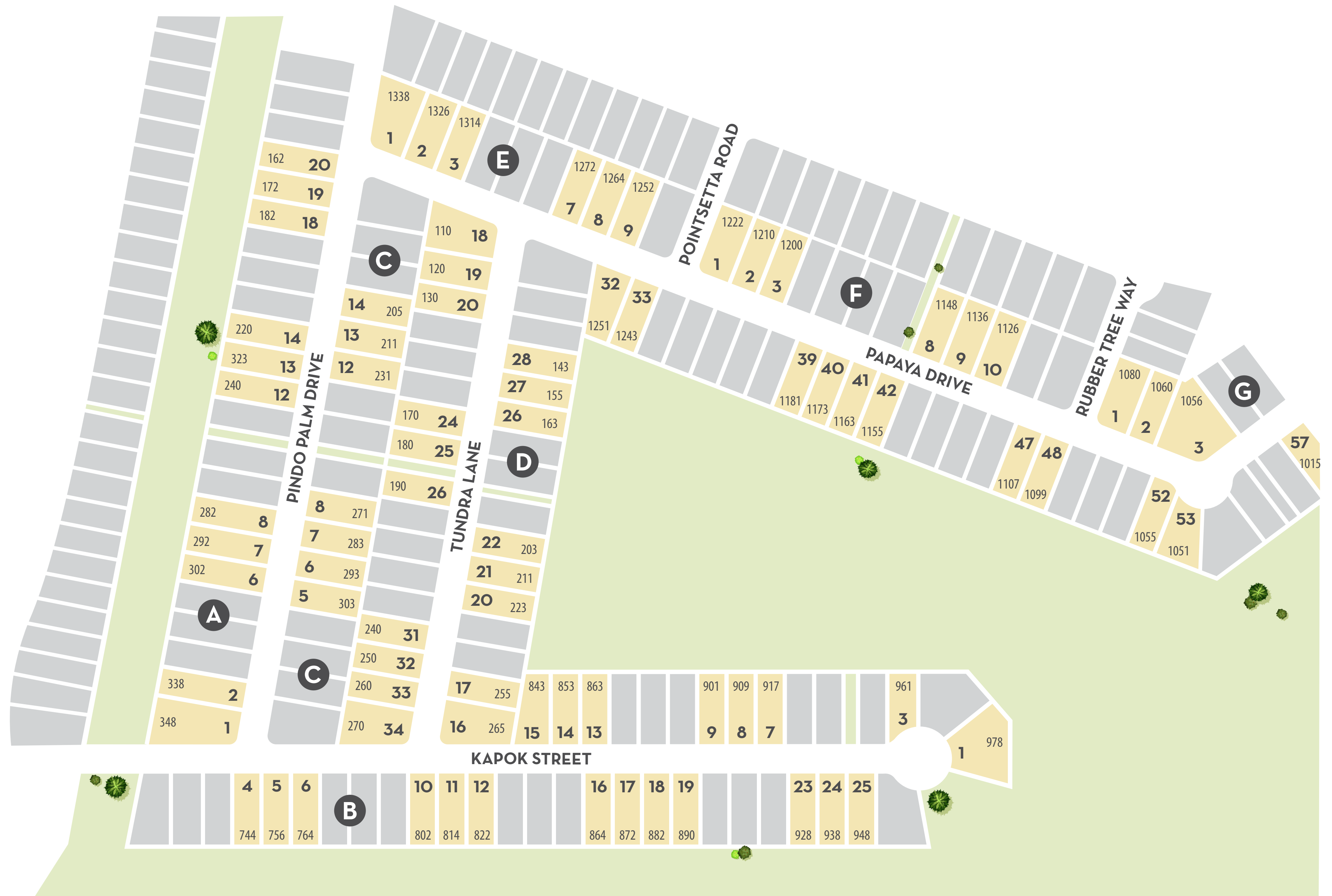

● INVENTORY ● AVAILABLE ● SOLD ● CLOSED

COMMUNITY BUILDER WITH A ROCK SOLID FOUNDATION

C-ROCK.COM



Sunfield

Cobalt Series

45' homesites

04/15/26

One-Story Homes			Base Price
Comal	1604	3 bedrooms, 2 bathrooms, massive family room, integrated kitchen and breakfast area, formal dining, optional covered patio, optional study or bedroom #4	\$339,990
Aquila	1772	3 bedrooms, 2 bathrooms, open concept family room, kitchen and dining area, optional study, and optional covered patio	\$345,990
Pedernales	1800	4 bedrooms, 2 bathrooms, open concept family room, kitchen and dining area, optional study, optional covered patio	\$349,990
Sabine	1915	3 bedrooms, 2 bathrooms, integrated kitchen, dining and family room, home office, optional covered patio and optional master luxury bath	\$363,990
Two-Story Homes			
Brazos	2213	4 bedrooms, 3 bathrooms, integrated kitchen, dining & family room, and an upstairs bonus room. Optional features include covered patio, master luxury bath, master super shower, and study.	\$374,990
Blanco	2280	4 bedrooms, 2.5 bathrooms, open concept family room and kitchen, 2-story dining room, study, 2nd floor game room. Optional Features: covered patio and master luxury bath	\$385,990
Rio Grande	2507	4 bedrooms, 2.5 bathrooms, 2-story family room, integrated kitchen and breakfast area, study, 2nd floor game room, optional covered patio	\$397,990
Trinity	2513	4 bedrooms, 2.5 bathrooms, 2-story family room, integrated kitchen and breakfast area, study or optional bedroom #5, 2nd floor game room, optional covered patio	\$399,990
Concho	2817	4 bedrooms, 3.5 bathrooms, open concept 2-story family room, kitchen and breakfast area, study or optional bedroom #5, 2nd floor game room, optional covered patio	\$412,990





Sunfield

Silver Series

50' Homesites

04/15/26

One-Story Homes			Base Price
Aspen	1651	3 bedrooms, 2 bathrooms, large family room, integrated kitchen and casual dining area, covered patio option	\$348,990
Apache	1666	3 bedrooms, 2 bathrooms, open concept kitchen, dining, and family room area, covered patio option, study or optional bedroom #4	\$355,990
Greeley	1801	3 bedrooms, 2 bathrooms, open concept kitchen, dining, and family room area, spacious pantry and walk-in closets, covered patio option	\$375,990
Comanche	1850	3 bedrooms, 2 bathrooms, integrated kitchen, dining, and family room area, study. Optional fireplace and covered patio	\$378,990
Creede	2009	3 bedrooms, 2 bathrooms, study, large family room, integrated kitchen with dining area. Optional features: bedroom #4 and covered patio	\$384,990
Glenwood Model	2264	3 bedrooms, 2 bathrooms, open concept kitchen, dining, and family room area, covered patio option, study or optional bedroom #4, optional 2nd floor bonus room	\$397,990
Two-Story Homes			
Yuma	2575	4 bedrooms, 3 bathrooms, open concept kitchen, dining and 2-story family room area. Optional features: fireplace and covered patio	\$436,990
San Marcos	2697	4 bedrooms, 2.5 bathrooms, integrated kitchen and dining, 2-story family room, spiral staircase, game room, optional covered patio	\$439,990
Hayden	2809	4 bedrooms, 2.5 bathrooms, large kitchen and dining area that opens into the family room, study, game room, media room. Optional features: bedroom #5 and bath #3 in lieu of media, bedroom #6 and bath #4 in lieu of study	\$452,990
Snowmass	3313	4 bedrooms, 3.5 bathrooms, open concept layout, 2-story formal dining and family room, kitchen with island, study, game room, media room, optional covered patio	\$473,990
Southfork Model	3542	5 bedrooms, 4 bathrooms, open concept layout with spacious family room, study, formal dining room, mud room, two master bedroom closets, upstairs game room, and covered balcony. Options include designer kitchen, 3-car garage, super showers, bedroom #6 and rear covered patio	\$502,990





Sunfield 60's

Silver Series

60' Homesites

04/15/26

One-Story Homes

Base Price

Glenwood	2264	3 bedrooms, 2 bathrooms, open concept kitchen, dining, and family room area, covered patio option, study or optional bedroom #4, optional 2nd floor bonus room	\$430,990
--------------------------	------	--	-----------

Two-Story Homes

Yuma	2575	4 bedrooms, 3 bathrooms, open concept kitchen, dining and 2-story family room area. Optional features: fireplace and covered patio	\$480,990
----------------------	------	--	-----------

Hayden	2809	4 bedrooms, 2.5 bathrooms, large kitchen and dining area that opens into the family room, study, game room, media room. Optional features: bedroom #5 and bath #3 in lieu of media, bedroom #6 and bath #4 in lieu of study	\$493,990
------------------------	------	---	-----------

Snowmass	3313	4 bedrooms, 3.5 bathrooms, open concept layout, 2-story formal dining and family room, kitchen with island, study, game room, media room, optional covered patio	\$513,990
--------------------------	------	--	-----------

Southfork	3542	5 bedrooms, 4 bathrooms, open concept layout with spacious family room, study, formal dining room, mud room, two master bedroom closets, upstairs game room, and covered balcony. Options include designer kitchen, 3-car garage, super showers, bedroom #6 and rear covered patio	\$539,990
---------------------------	------	--	-----------

****3-Car Garage Included****





Sunfield

Gold Series

60' Homesites

04/15/26

One-Story Homes

Base Price

Capitola	2453	3 bedrooms, 2.5 bathrooms, open concept kitchen, dining, and family room area, study, covered patio. Optional Features: 2nd floor game room or Bedroom #4 with bath #3	\$514,990
--------------------------	------	--	-----------

Atascadero	2578	3 bedrooms, 2 bathrooms, open concept kitchen, dining, and family room area, covered patio, study, optional 2nd floor Gameroom with bedroom #4 and optional media room	\$528,990
----------------------------	------	--	-----------

Santa Barbara	2796	3 bedrooms, 2.5 bathrooms, open concept family room, kitchen, dining, and breakfast area combination, separate living area, enlarged covered patio	\$535,990
<i>*Includes 3-car tandem garage</i>			

Malibu	2799	3 bedrooms, 2.5 bathrooms, large kitchen and breakfast area that opens into the massive family room, study or optional bedroom #4 and covered patio.	\$543,990
------------------------	------	--	-----------

Two-Story Homes

Sonora	2971	4 bedrooms, 3 bathrooms, 3 car tandem garage, 2-story family room open to kitchen and dining area, covered patio, 2nd floor game room, and optional bedroom#5 with bathroom #4 in lieu of tandem garage.	\$578,990
<i>*Includes 3-car tandem garage</i>			

Fremont	3005	4 bedrooms, 3.5 bathrooms, open concept layout, large kitchen, formal dining, 2-story family room, sweeping staircase, game room, covered patio, study	\$593,990
-------------------------	------	--	-----------

Artesia	3254	4 bedrooms, 3.5 bathrooms, open concept layout, integrated kitchen, dining and 2-story family room, 2 bedrooms downstairs, study and cover patio, 2nd floor game room	\$599,990
-------------------------	------	---	-----------

Eureka	3409	4 bedrooms, 3 bathrooms, 3 car front-load garage, combined kitchen-breakfast area, formal dining, 2-story family room, game room, covered patio and optional study with powder bathroom or bedroom#5 with bathroom #4 in lieu of 3rd car garage.	\$622,990
<i>*Includes 3-car garage</i>			

Sausalito	3712	4 bedrooms, 3.5 bathrooms, rounded breakfast area, spiral staircase, and two story dining, his and hers walk-in closets, covered patio, study, game room, media room	\$646,990
---------------------------	------	--	-----------

Laguna II	4052	5 bedrooms, 3.5 bathrooms, open concept layout, breakfast area, formal living and dining, 2-story family room, sweeping staircase, game room, media, covered patio	\$661,990
---------------------------	------	--	-----------

Laguna III	4299	5 bedrooms, 4.5 bathrooms, open concept kitchen, breakfast area, and 2-story family room combination, formal dining, sweeping staircase, 2 bedrooms downstairs, and large covered patio, 2nd floor game room, media room and optional covered balcony	\$700,990
----------------------------	------	---	-----------





CASTLEROCK COMMUNITIES

QUALITY AND SUSTAINABILITY UNDER ONE ROOF

Today, it is easier than ever to live sustainably without sacrificing style. Throughout our many years of business, our buyers have trusted us to build safe, high-quality homes with them and their families' well-being in mind. CastleRock makes it possible to create a home that is beautiful, comfortable, and eco-friendly.



INSPIRED BY YOU

CastleRock was founded with one goal in mind; to build sustainable homes that reflect your true essence. Our team is committed to providing superior service with passionate execution, using your life, your personality and your dreams as the building block for your future home.

BUILDING A BETTER HOME

From energy and water efficiency to construction durability and an improved indoor environment, we are building homes that are better for you, your wallet, and the planet. Unique design elements combined with our modern features give every room in your home a luxurious feel that will last a lifetime.



YOUR HOME IS YOUR CASTLE

We believe this old adage remains more applicable today than ever before. Our homes are designed to create unique opportunities for our customers to satisfy their lifestyle needs. In a time of practicality, we continue to focus on adding unexpected flair. Variety of choices remains a key driver in our offering decisions in both our home plans and communities.